

# EC (AC TO DC) FAN

## 80\*80\*25mm

### RT8025 Series



DIMENSIONS DRAWING



外框材质:环保防火PBT  
 Frame:Thermoplastic PBT UL94-V0  
 扇叶材质:环保防火PBT  
 Impeller:Thermoplastic PBT UL94-V0  
 轴承结构:双滚珠或长寿命含油结构  
 Bearing system:2Ball or Long life sleeve  
 单体风扇重量:54g  
 Unit Weight:54g

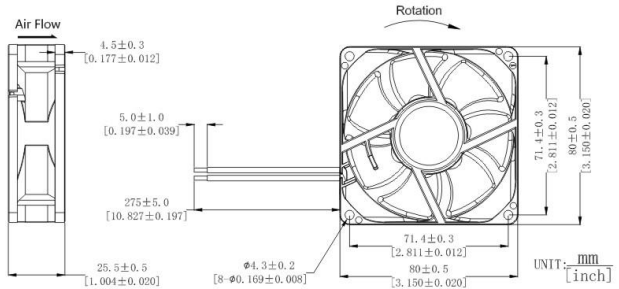

#### 可选的功能参照列表 (Available Functions)

1. 马达保护 (Motor protection)

RP	SS	AS	CL
○	●	●	●

2. 信号输出 (Signal output)

FG	RD	RD	LD
●	●	●	●

3. 调速方式 (Speed control mode)

PWM	TP	VC	RC	CS
●	●	●	●	●

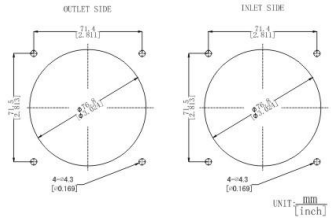
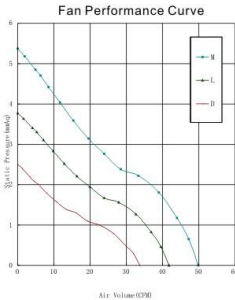

Part Number	Voltage(V)	Fre. (HZ)	Power(W)	Speed(RPM)	Air flow(Q)	Pressure(P)	Noise(dBA)
产品编号	电压范围	频率范围	功率	转速	(CFM) 风量	m <sup>3</sup> /min	(Mmaq) 风压 (In H <sub>2</sub> O) 噪音
RT8025x11D	110(80~120)	45~65	3.0	2400	34.86	0.99	2.45 0.10 29.9
RT8025x11L		45~65	3.8	3000	43.23	1.22	3.77 0.15 34.8
RT8025x11M		45~65	4.2	3600	51.59	1.46	5.37 0.21 38.3
RT8025x22D	220(120~240)	45~65	3.0	2400	34.86	0.99	2.45 0.10 29.9
RT8025x22L		45~65	3.8	3000	43.23	1.22	3.77 0.15 34.8
RT8025x22M		45~65	4.2	3600	51.59	1.46	5.37 0.21 38.3

- ★ 如果您需要的转速或电压或功能不在这份清单上, 请与我们联系。  
If you want another rpm or voltage or functions which one is not in the list, please contact with our sales.
- ★ 提示1:功能的具体信息参照产品目录前页篇章。  
Notes1:The catalog have detail information in the front page for the functions.
- ★ 提示2:产品详细信息请参照承诺书。  
Notes2:Product have a detail in the approval sheet.
- ★ 提示3:产品规格变更不另行通知。  
Notes3:Specifications are subject to change without notice.
- ★ 提示4:该款机型可制作相同转速的, 可在AC110V和AC220V双电压下使用。  
Note4:This model can be made in the same speed and used in AC110V, AC220V both.