

**60**mm sq.**San Ace 60WF****General Specifications**

- Material.....Frame: Plastics (Flammability: UL94V-0),  
Impeller: Plastics (Flammability: UL94V-0)
- Expected Life .....Refer to specifications (L10:Survival rate: 90% at 60°C ,  
rated voltage, and continuously run in a free air state)
- Lead Wire .....⊕red ⊖black (Sensor) yellow
- Storage Temperature ...-30°C to +70°C (Non-condensing)

The product can be used in an oil mist environment\*

\*Environment where machining oil mist is scattered.  
Usage of this product requires an evaluation with the oil that will be used.

**60×60×25mm** [Mass : 110g] **9WFtype****Specifications** The following nos. **have pulse sensors and ribs.**

Model No.	Rated Voltage [V]	Operating Voltage Range [V]	Rated Current [A]	Rated Input [W]	Rated Speed [min <sup>-1</sup> ]	Max. Airflow [m <sup>3</sup> /min] [CFM]	Max. Static Pressure [Pa] [inchH <sub>2</sub> O]	SPL [dB(A)]	Operating Temperature [°C]	Expected Life [h]
<b>9WF0624H401</b>	24	20.4 to 27.6	0.15	3.6	6,500	0.67 23.6	97 0.38	41	- 20 to + 70	40,000/60°C

Other sensor specifications are available as options. Please refer to the index (p. 511).

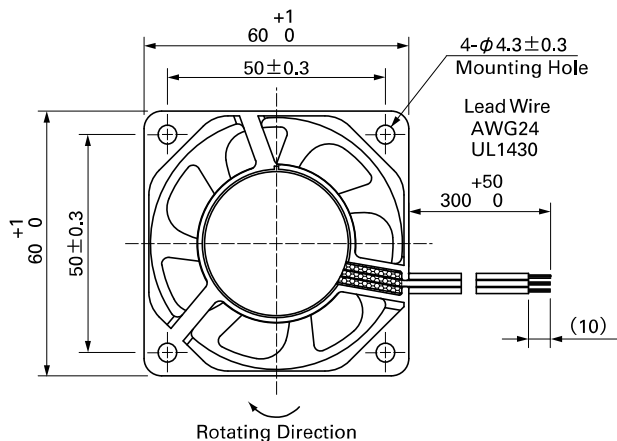
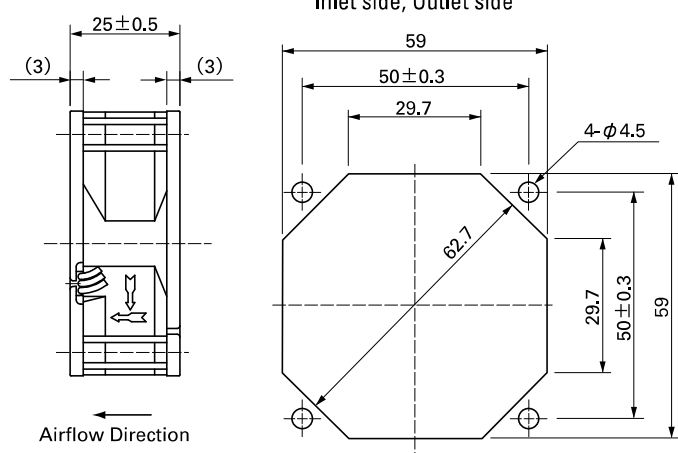
**Dimensions (unit: mm)****Reference Dimensions of Mounting Holes and Vent Opening (unit: mm)****Options (unit: mm)****Finger Guards**

Model : 109-139E Surface treatment : Nickel-chrome plating (silver)  
: 109-139H : Cation electropainting (black)

Color

Inlet side, Outlet side

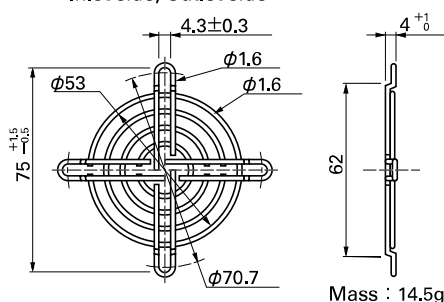
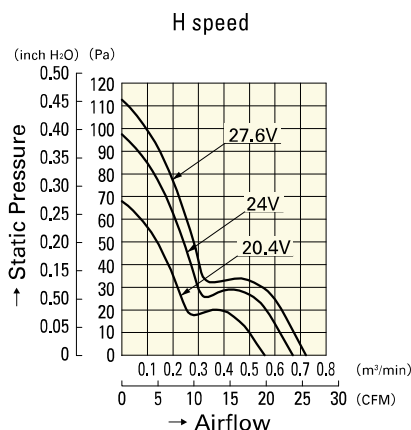
**Airflow - Static Pressure Characteristics****9WF0624H401**